

NEXIS CLICK-ON 05

95° profiled door hinge (Door thicknesses up to 30 mm)



- 95° opening angle
- Minimum reveals with thick doors
- Soft-close compatible
- Optimum reveals for door thicknesses up to 26 mm
- 3-dimensional adjustment with appropriate mounting plate

Available in 2 versions:

- With self-closing mechanism (spring)
- Without self-closing mechanism (spring) for use with Tipmatic

ORDER INFORMATION

Door overlay		Material		Cranking	with spring	Item No.	
		Cup	Arm			Click-on Screw fixing	Click-on Press fitting
Full overlay		Steel, nickel-plated	Steel, nickel-plated	0	■	F015072742	F015072741
					-	F015072743	-
Half overlay		Steel, nickel-plated	Steel, nickel-plated	8	■	F015072760	-
					-	F015072762	-
Inset		Steel, nickel-plated	Steel, nickel-plated	15	■	F015072768	F015072767
					-	F015072770	-

COVER CAPS

	Designation	Cranking	Imprinted/Embossed	Item No.
	Hinge arm cover cap, steel, short, nickel-plated, not imprinted, Soft-close compatible	0	On request	F069073570
	Hinge arm cover cap, steel, open, nickel-plated, not imprinted, Soft-close compatible	8/15	On request	F069073669

ACCESSORIES

	Designation	Item No.		Designation	Item No.
	Tipmatic Plus Click-on set	F069073752		Countersunk wood screw Ø 3.5 x 15 mm	F146073976
	Soft-close Click-on set	F069073714		Hinge cup cover cap, steel, nickel-plated, not imprinted	F069073687

Nexis Click-on mounting plates	218
Accessories	226

Soft-close Click-on	286
Tipmatic Plus Click-on	302

Technical information	228
Assembly aids	364

INSTALLATION INFORMATION

All dimensions in millimetres

Full overlay	K0	Half overlay	K8	Inset	K15																																																																																																																																																																																																																																	
<p>Mounting plate height 2</p> <table border="1"> <tr> <td rowspan="12">Door overlay</td> <th>0</th> <th colspan="5">Cup distance</th> </tr> <tr> <td></td> <th>3</th> <th>4</th> <th>5</th> <th>6</th> <td></td> </tr> <tr> <td>19</td> <td></td> <td></td> <td></td> <td>0</td> <td></td> </tr> <tr> <td>18</td> <td></td> <td></td> <td>0</td> <td></td> <td></td> </tr> <tr> <td>17</td> <td></td> <td>0</td> <td></td> <td>2</td> <td></td> </tr> <tr> <td>16</td> <td>0</td> <td></td> <td>2</td> <td>3</td> <td></td> </tr> <tr> <td>15</td> <td></td> <td>2</td> <td>3</td> <td>4</td> <td></td> </tr> <tr> <td>14</td> <td>2</td> <td>3</td> <td>4</td> <td></td> <td></td> </tr> <tr> <td>13</td> <td>3</td> <td>4</td> <td></td> <td></td> <td></td> </tr> <tr> <td>12</td> <td>4</td> <td></td> <td></td> <td></td> <td></td> </tr> <tr> <td></td> <td></td> <td></td> <td></td> <td></td> <td></td> </tr> <tr> <td colspan="6">Mounting plate height</td> </tr> </table>		Door overlay	0	Cup distance						3	4	5	6		19				0		18			0			17		0		2		16	0		2	3		15		2	3	4		14	2	3	4			13	3	4				12	4											Mounting plate height						<p>Mounting plate height 2</p> <table border="1"> <tr> <td rowspan="12">Door overlay</td> <th>8</th> <th colspan="5">Cup distance</th> </tr> <tr> <td></td> <th>3</th> <th>4</th> <th>5</th> <th>6</th> <td></td> </tr> <tr> <td>11</td> <td></td> <td></td> <td></td> <td>0</td> <td></td> </tr> <tr> <td>10</td> <td></td> <td></td> <td>0</td> <td></td> <td></td> </tr> <tr> <td>9</td> <td></td> <td>0</td> <td></td> <td>2</td> <td></td> </tr> <tr> <td>8</td> <td>0</td> <td></td> <td>2</td> <td>3</td> <td></td> </tr> <tr> <td>7</td> <td></td> <td>2</td> <td>3</td> <td>4</td> <td></td> </tr> <tr> <td>6</td> <td>2</td> <td>3</td> <td>4</td> <td></td> <td></td> </tr> <tr> <td>5</td> <td>3</td> <td>4</td> <td></td> <td></td> <td></td> </tr> <tr> <td>4</td> <td>4</td> <td></td> <td></td> <td></td> <td></td> </tr> <tr> <td></td> <td></td> <td></td> <td></td> <td></td> <td></td> </tr> <tr> <td colspan="6">Mounting plate height</td> </tr> </table>		Door overlay	8	Cup distance						3	4	5	6		11				0		10			0			9		0		2		8	0		2	3		7		2	3	4		6	2	3	4			5	3	4				4	4											Mounting plate height						<p>Mounting plate height 4</p> <table border="1"> <tr> <td rowspan="12">Door reveal</td> <th>15</th> <th colspan="5">Cup distance</th> </tr> <tr> <td></td> <th>3</th> <th>4</th> <th>5</th> <th>6</th> <td></td> </tr> <tr> <td>0</td> <td></td> <td>2</td> <td>3</td> <td>4</td> <td></td> </tr> <tr> <td>1</td> <td>2</td> <td>3</td> <td>4</td> <td></td> <td></td> </tr> <tr> <td>2</td> <td>3</td> <td>4</td> <td></td> <td></td> <td></td> </tr> <tr> <td></td> <td></td> <td></td> <td></td> <td></td> <td></td> </tr> <tr> <td></td> <td></td> <td></td> <td></td> <td></td> <td></td> </tr> <tr> <td></td> <td></td> <td></td> <td></td> <td></td> <td></td> </tr> <tr> <td></td> <td></td> <td></td> <td></td> <td></td> <td></td> </tr> <tr> <td></td> <td></td> <td></td> <td></td> <td></td> <td></td> </tr> <tr> <td></td> <td></td> <td></td> <td></td> <td></td> <td></td> </tr> <tr> <td></td> <td></td> <td></td> <td></td> <td></td> <td></td> </tr> <tr> <td colspan="6">Mounting plate height</td> </tr> </table>		Door reveal	15	Cup distance						3	4	5	6		0		2	3	4		1	2	3	4			2	3	4																																														Mounting plate height					
Door overlay	0		Cup distance																																																																																																																																																																																																																																			
			3	4	5	6																																																																																																																																																																																																																																
	19					0																																																																																																																																																																																																																																
	18				0																																																																																																																																																																																																																																	
	17			0		2																																																																																																																																																																																																																																
	16		0		2	3																																																																																																																																																																																																																																
	15			2	3	4																																																																																																																																																																																																																																
	14		2	3	4																																																																																																																																																																																																																																	
	13		3	4																																																																																																																																																																																																																																		
	12		4																																																																																																																																																																																																																																			
	Mounting plate height																																																																																																																																																																																																																																					
Door overlay	8	Cup distance																																																																																																																																																																																																																																				
		3	4	5	6																																																																																																																																																																																																																																	
	11				0																																																																																																																																																																																																																																	
	10			0																																																																																																																																																																																																																																		
	9		0		2																																																																																																																																																																																																																																	
	8	0		2	3																																																																																																																																																																																																																																	
	7		2	3	4																																																																																																																																																																																																																																	
	6	2	3	4																																																																																																																																																																																																																																		
	5	3	4																																																																																																																																																																																																																																			
	4	4																																																																																																																																																																																																																																				
	Mounting plate height																																																																																																																																																																																																																																					
Door reveal	15	Cup distance																																																																																																																																																																																																																																				
		3	4	5	6																																																																																																																																																																																																																																	
	0		2	3	4																																																																																																																																																																																																																																	
	1	2	3	4																																																																																																																																																																																																																																		
	2	3	4																																																																																																																																																																																																																																			
Mounting plate height																																																																																																																																																																																																																																						

MINIMUM GAP

Door thickness	Cup distance				
		3	4	5	6
	16	0.5	0.5	0.5	0.5
	18	0.5	0.5	0.5	0.5
	19	0.5	0.5	0.5	0.5
	20	0.5	0.5	0.5	0.5
	22	0.5	0.5	0.5	0.5
	24	0.5	0.5	0.5	0.5
	26	0.5	0.5	0.5	0.7
	28	0.5	0.5	0.5	0.9
	30	0.5	0.5	1.1	1.1
	Minimum gap				

MINIMUM REVEAL

Door thickness	Cup distance				
		3	4	5	6
	16	0.1	0.1	0.1	0.1
	18	0.2	0.2	0.2	0.2
	19	0.3	0.3	0.3	0.3
	20	0.4	0.4	0.4	0.4
	22	0.7	0.7	0.7	0.7
	24	1.0	1.0	1.0	1.0
	26	1.4	1.4	1.4	1.4
	28	1.9	1.9	1.9	1.9
	30	3.8	2.9	2.6	2.5
	Minimum reveal (F)				

NOTES

The minimum gap is the clearance required between the front edge of the cabinet and the closed door so that the door can open without hindrance.

Important: Reveals were calculated for doors with a radius of 1 mm!

Hinge dimensions and reveal calculation with factory setting.

We recommend a trial fitting.

DRILLING PATTERNS

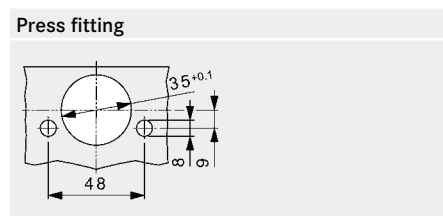
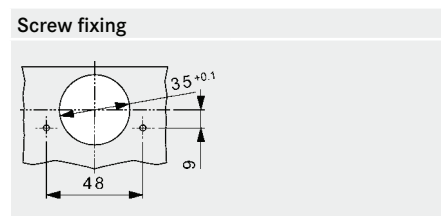

CUP DIMENSIONS

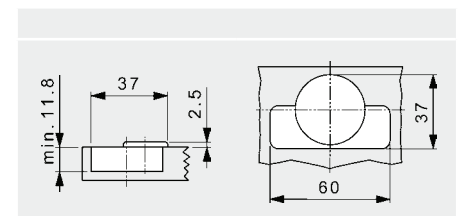

Tiomos
Nexis
Special hinges
Single-joint hinges
Cabinet making accessories